

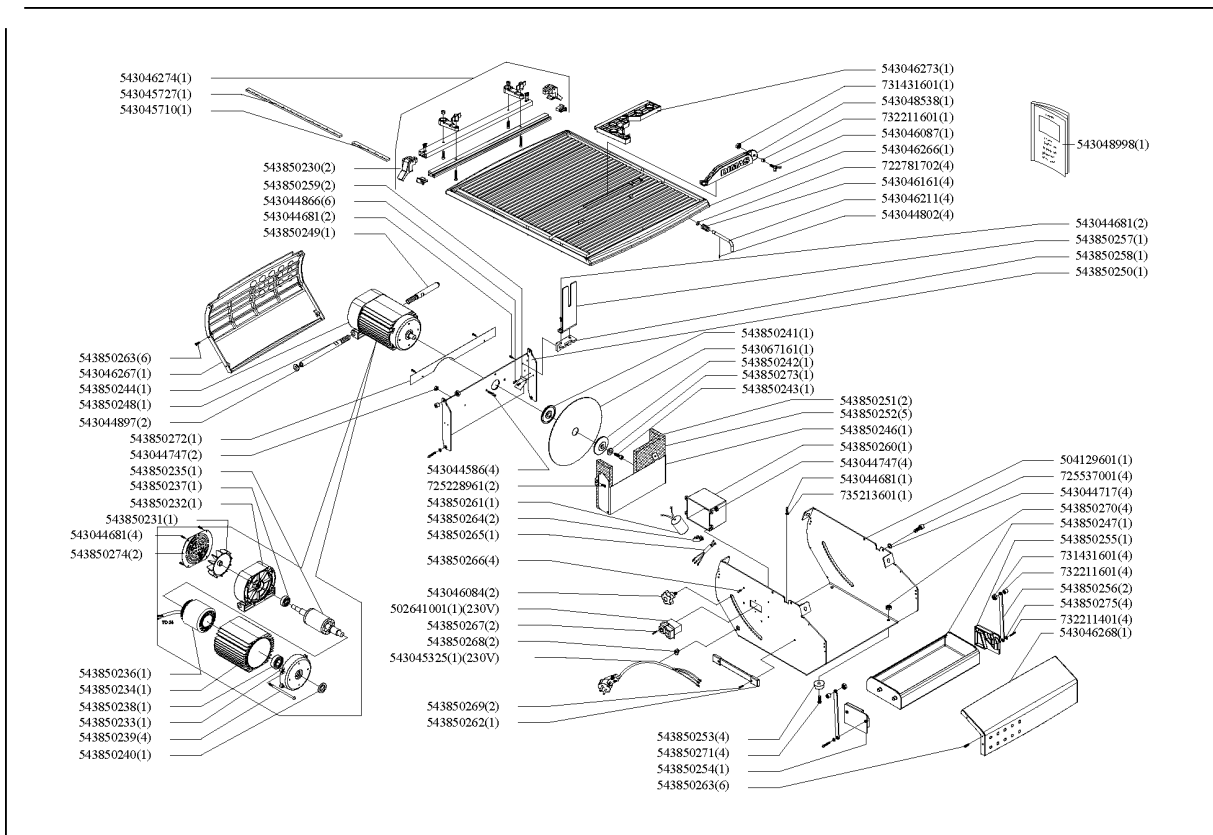

SPARE PARTS LIST

TILE SAWS

TS230 F, 2007-03



| Ref | Part No | Description | Remark | QTY KIT |
|-----------|--------------|--------------------------------|--------|---------|
| 502641001 | 502 64 10-01 | SWITCH | | 1 |
| 504129601 | 504 12 96-01 | FRAME | | 1 |
| 543044586 | 543 04 45-86 | VIS TH 8/8 5X16 BICHROM/ | | 4 |
| 543044681 | 543 04 46-81 | VIS TOLE T CBL CRUCIFORM/3.9X9 | | 2 |
| 543044681 | 543 04 46-81 | VIS TOLE T CBL CRUCIFORM/3.9X9 | | 1 |
| 543044681 | 543 04 46-81 | VIS TOLE T CBL CRUCIFORM/3.9X9 | | 2 |
| 543044681 | 543 04 46-81 | VIS TOLE T CBL CRUCIFORM/3.9X9 | | 4 |
| 543044717 | 543 04 47-17 | WASHER | | 4 |
| 543044747 | 543 04 47-47 | ECROU HH 4 BICHRO/ | | 2 |
| 543044747 | 543 04 47-47 | ECROU HH 4 BICHRO/ | | 4 |
| 543044802 | 543 04 48-02 | GOUPILLE ELASTIQUE 3X15/ | | 4 |
| 543044866 | 543 04 48-66 | RIVET 4*21.5 BF 01 0523/ | | 6 |
| 543044897 | 543 04 48-97 | ENTRETOISE 30/10.5/3/ | | 2 |
| 543045325 | 543 04 53-25 | CORDON HO5W-F 3G0.75/1.6M AS | | 1 |
| 543045710 | 543 04 57-10 | REGLET GAUCHE L 170/ | | 1 |
| 543045727 | 543 04 57-27 | REGLET AVANT 320 12"1/2"/ | | 1 |
| 543046084 | 543 04 60-84 | STEERING WHEEL | | 2 |
| 543046087 | 543 04 60-87 | GALET GP/34 6X15 6310055/ | | 1 |
| 543046161 | 543 04 61-61 | RESSORT N' 11344/ | | 4 |
| 543046211 | 543 04 62-11 | AXE BLOCAGE/ | | 4 |
| 543046266 | 543 04 62-66 | TABLE/ | | 1 |
| 543046267 | 543 04 62-67 | COUVERCLE MOTEUR/ | | 1 |
| 543046268 | 543 04 62-68 | COUVERCLE AVANT/ | | 1 |
| 543046273 | 543 04 62-73 | GUIDE ANGULAIRE/ | | 1 |
| 543046274 | 543 04 62-74 | S/E GUIDE DE COUPE 38360/ | | 1 |
| 543048538 | 543 04 85-38 | CARTER BLADE TS230F/ | | 1 |
| 543048998 | 543 04 89-98 | NOTICE TS230F/ | | 1 |
| 543067161 | 543 06 71-61 | DIAMOND BLADE | | 1 |
| 543850230 | 543 85 02-30 | CLIPS-RULER ASSY | | 2 |
| 543850231 | 543 85 02-31 | FAN | | 1 |
| 543850232 | 543 85 02-32 | MOTOR TAIL COVER | | 1 |
| 543850233 | 543 85 02-33 | MOTOR FRONT COVER | | 1 |
| 543850234 | 543 85 02-34 | MOTOR HOUSING | | 1 |
| 543850235 | 543 85 02-35 | ROTOR | | 1 |
| 543850236 | 543 85 02-36 | STATOR | | 1 |
| 543850237 | 543 85 02-37 | MOTOR REAR BEARING | | 1 |
| 543850238 | 543 85 02-38 | MOTOR FRONT BEARING | | 1 |
| 543850239 | 543 85 02-39 | STATOR SCREWS | | 4 |
| 543850240 | 543 85 02-40 | SEAL | | 1 |
| 543850241 | 543 85 02-41 | INNER FLANGE | | 1 |
| 543850242 | 543 85 02-42 | OUTER FLANGE | | 1 |
| 543850243 | 543 85 02-43 | BLADE FIXING BOLT | | 1 |
| 543850244 | 543 85 02-44 | COMPLETE MOTOR UNIT | 230 V | 1 |
| 543850244 | 543 85 04-30 | COMPLETE MOTORUNIT(110V) | 115V | 1 |
| 543850246 | 543 85 02-46 | LOWER BLADE SHROUD | | 1 |
| 543850247 | 543 85 02-47 | WATER TRAY | | 1 |
| 543850248 | 543 85 02-48 | MOTOR SWIVEL AXLE-LONG | | 1 |
| 543850249 | 543 85 02-49 | MOTOR SWIVEL AXLE-SHORT | | 1 |
| 543850250 | 543 85 02-50 | FRONT MOTOR SUPPORT | | 1 |
| 543850251 | 543 85 02-51 | TURF MUD GUARD-LARGE | | 2 |
| 543850252 | 543 85 02-52 | TURF MUD GUARD-SMALL | | 5 |
| 543850253 | 543 85 02-53 | FOOT PAD | | 4 |
| 543850254 | 543 85 02-54 | WATER TRAY SUPPORT-LEFT | | 1 |
| 543850255 | 543 85 02-55 | WATER TRAY SUPPORT-RIGHT | | 1 |
| 543850256 | 543 85 02-56 | CONNECTING ROD | | 2 |
| 543850257 | 543 85 02-57 | SEPARATOR | | 1 |
| 543850258 | 543 85 02-58 | SEPARATOR SUPPORTBRACKET | | 1 |
| 543850259 | 543 85 02-59 | DEFLECTOR | | 2 |
| 543850260 | 543 85 02-60 | SWITCH BOX | | 1 |
| 543850261 | 543 85 02-61 | CONDENSATOR | | 1 |
| 543850262 | 543 85 02-62 | STRAP | | 1 |
| 543850263 | 543 85 02-63 | AUTO THREADING SCREW | | 6 |
| 543850263 | 543 85 02-63 | AUTO THREADING SCREW | | 6 |
| 543850264 | 543 85 02-64 | CONNECTOR BLOCK | | 2 |

PRODUCT COMPLETE

TS230 F, 2007-03

| Ref | Part No | Description | Remark | QTY KIT |
|-----------|--------------|-----------------------|--------|---------|
| 543850265 | 543 85 02-65 | LEAD WIRE | | 1 |
| 543850266 | 543 85 02-66 | SCREW | | 4 |
| 543850267 | 543 85 02-67 | FLAT HEAD SCREW | | 2 |
| 543850268 | 543 85 02-68 | GLAND PACKING | | 2 |
| 543850269 | 543 85 02-69 | FLAT HEAD SCREW | | 2 |
| 543850270 | 543 85 02-70 | NYLOC NUT | | 4 |
| 543850271 | 543 85 02-71 | SCREW | | 4 |
| 543850272 | 543 85 02-72 | SPLASH SHIELD STRIP | | 1 |
| 543850273 | 543 85 02-73 | FLAT WASHER | | 1 |
| 543850274 | 543 85 02-74 | MOTOR FAN COVER PLATE | | 2 |
| 543850275 | 543 85 02-75 | FLAT WASHER | | 4 |
| 722781702 | 722 78 17-02 | BLIND RIVET | | 4 |
| 725228961 | 725 22 89-61 | SCREW EHHF | | 2 |
| 725537001 | 725 53 70-01 | SCREW IHSCM | | 4 |
| 731431601 | 731 43 16-01 | HEXAGON THIN NUT | | 1 |
| 731431601 | 731 43 16-01 | HEXAGON THIN NUT | | 4 |
| 732211401 | 732 21 14-01 | LOCK NUT | | 4 |
| 732211601 | 732 21 16-01 | NUT | | 4 |
| 732211601 | 732 21 16-01 | NUT | | 1 |
| 735213601 | 735 21 36-01 | LOCK WASHER | | 1 |